

5 Shrewsbury Terrace, Butts Hill, Sheffield S17 4AN

5 Shrewsbury Terrace, Butts Hill

Sheffield, S17 4AN

Description

Tucked away at the top of Butts Hill, forming part of the attractive 'Shrewsbury Terrace' and situated in the very heart of Old Totley this gorgeous cottage has a lovely, modernised finish throughout. The location is highly sought after, a moments' walk away from the award winning catering establishments and public houses in the immediate area not to mention the glorious surrounding countryside which offers plenty of opportunities to explore and the 'outstanding' local schools. The property is ideal for the owner occupier or investor market alike and has a lovely feel. Offering a superb range of deceptively spacious accommodation over three floors to include a large, occasional attic room that is currently utilised as a home office, a luxurious bathroom, double bedroom and a sitting room boasting a wood burning stove that will brighten any mood during the long winter months. There is an off road parking bay at the front and a low maintenance garden area at the rear making a very pleasant sitting out area in the warmer summer months while not being too onerous to maintain. All in all a superb property which is complemented by the very desirable area.

- One double bedroom with a pretty, decorative fireplace.
- Fitted kitchen with integrated fridge and washing machine.
- Sitting room with a beamed ceiling and a cosy wood burning stove.
- Luxurious shower room with generous proportions.
- Occasional room on the second floor that is currently utilised as a home office.
- Off road parking for one car.
- Low maintenance rear garden.
- No onward chain.
- Freehold and EPC rating D-61.
- Timber double glazing and gas central heating via a combination boiler.





Ground Floor

Approx. 24.4 sq. metres (262.8 sq. feet)

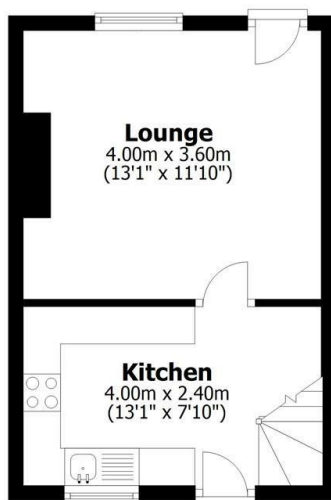

First Floor

Approx. 24.4 sq. metres (262.8 sq. feet)



Second Floor

Approx. 14.0 sq. metres (150.3 sq. feet)

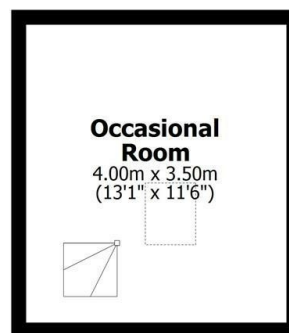

Total area: approx. 62.8 sq. metres (675.9 sq. feet)

All measurements are approximate
Yorkshire EPC & Floor Plans Ltd
Plan produced using PlanUp.



Bakewell

3 Royal Oak Place
Matlock Street
Bakewell DE45 1HD
T: 01629 700699
E: bakewell@elr.co.uk

Banner Cross

888 Ecclesall Road
Banner Cross
Sheffield S11 8TP
T: 01142 683388
E: bannercross@elr.co.uk

Dore

33 Townhead Road
Sheffield
S17 3GD
T: 0114 2362420
E: dore@elr.co.uk

Hathersage

Main Road, Hathersage
Hope Valley
Derbyshire S32 1BB
T: 01433 651888
E: peakdistrict@elr.co.uk

Rotherham

149 Bawtry Road
Wickersley
Rotherham S66 2BW
T: 01709 917676
E: wickersley@elr.co.uk

**EADON
LOCKWOOD
& RIDDLE**
ESTD 1840

All rooms have been measured with electronic laser and are approximate measurements only. None of the services to the above property have been tested by ourselves, and we cannot guarantee that the installations described in the details are in perfect working order. Eadon Lockwood & Riddle for themselves, and for the vendors or lessors, produce these brochures in good faith, and are a guideline only. They do not constitute any part of a contract and are correct to the best of our knowledge at the time of going to press.